

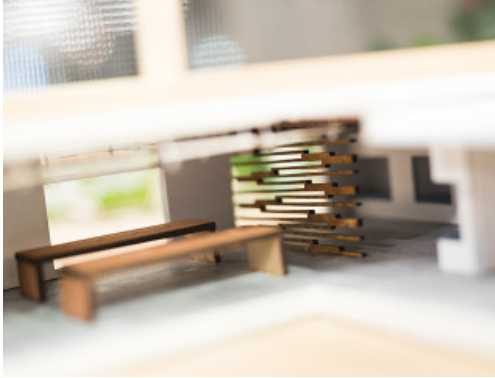

Bachelor of Architectural Studies (Architectural Technology) or (Interior Architecture)



Domestic fee: \$8,632 (first year)

International fee: \$24,620 (first year)

Compulsory student levy >
StudyLink >

*Fees are approximate, subject to change and exchange rates

Location	Dunedin
Duration	Three years full-time or five years part-time
Delivery	On campus

Credits	360
Level	7
Start	February
Apply	Now

PORTFOLIO REQUIREMENTS

Gain the skills you need to pursue a career in architectural design and the building industry.

Prepare to work as an Architectural Technologist or for further study if you want to become an Architect or Interior Architect. In addition, this programme will enable you to develop your awareness of the social responsibilities of designers and technologists within the built environment.

Why study Architectural Studies with us?

This programme will give you the analytical and conceptual skills to put your creative ideas into practice, and the academic skills to pursue higher levels of study. You will have the knowledge and skills in drawing, computer-aided design (CAD), building construction and science to bring your designs to life in accordance with legislation and codes.

Benefits of studying with us

- > Fantastic work prospects and opportunities to design locally, nationally and internationally
- > Individual options available to specialise through electives
- > The opportunity to demonstrate your talent through design competitions
- > Successful completion will enable you to pursue postgraduate study in Architecture.

Read more about the great resources we offer when you study with us.

Entry requirements

- > NCEA Level 3
- > 14* credits at Level 3 in each of three NZQA approved university entrance subjects, and

> 10 Literacy credits at Level 2 or above, made up of:

> 5 credits in reading and 5 credits in writing, and

> 10 Numeracy credits at Level 1 or above, made up of:

> specified achievement standards available through a range of subjects OR

> package of three numeracy unit standards (26623, 26626, 26627- all three required).

*Due to Covid-19 disruption, if you studied and achieved NCEA Level 3 during 2020 you only need 12 credits per Level 3 subject (i.e. a total of 36 credits).

> International students will be individually assessed to ensure they have an acceptable level of secondary school achievement.

> If English is not your first language, you must provide:

> New Zealand University Entrance OR

> Overall Academic IELTS 6.5 with no individual band score lower than 6.0 (achieved in one test completed in the last two years), OR

> Acceptable alternative evidence of the required IELTS (see here for NZQA proficiency table and here for list of recognised proficiency tests).

If you need to improve your English Language skills, we offer a wide range of English programmes.

Alternative requirements

> Evidence of literacy, numeracy and an ability to study at the appropriate level. This can be through study, work and/or life experience. Otago Polytechnic literacy assessments are available.

Other requirements

> You must provide a portfolio . Please see below for details of the portfolio requirements or email ebsDES@op.ac.nz for more information.

> Applicants should be motivated and talented individuals with a strong interest in and aptitude for the technological and/or creative fields of architecture.

Your portfolio

You need to submit a portfolio that demonstrates your design, graphic and/or art skills equivalent to NCEA Level 3. We will assess your portfolio against these criteria: composition, concepts - ideas and content, variety and range of media, and drawing skills.

Find out what you need to include in your portfolio, what we're looking for, and how to submit it to us.

Selection process

Selection is based on your portfolio and your previous secondary or tertiary academic record or work and/or life experiences. We accept applications until late November, but early applications get priority. We will process late applications in the order we receive them and create a wait list if we receive more applications than there are places available.

We may need to interview you to determine if you meet alternative entry requirements for special admission. If you are sitting NCEA you may be accepted conditionally pending notification of your NCEA results. It is your responsibility to contact us once you have your results. In the event that you don't achieve the required result, we will reassess your application and suggest alternatives.

Additional costs

Per academic year, you will be expected to spend about \$750-\$900 on course-related materials.

Qualification structure

This qualification offers two specialisation options: Architectural Technology or Interior Architecture. You will learn about architectural design theory as well as the evolution of architectural design through time. You will also learn how to communicate relevant information effectively to the various stakeholders of the industry.

Year 1		Year 2		Year 3	
Semester 1	Semester 2	Semester 1	Semester 2	Semester 1	Semester 2
Contextual Studies 1	Contextual Studies 1	Contextual Studies 2	Elective	Elective	Elective
Architectural Science	Architectural Science	Architectural Technologies	Architectural Technologies	Research Project	Elective

Construction	Construction	Documentation Studio 2	Documentation Studio 2	Architectural Design Studio 3	Design Studio Major
Architectural Design Studio 1	Architectural Design Studio 1	Architectural Design Studio 2	Architectural Design Studio 2	Architectural Design Studio 3	Design Studio Major
Documentation Foundation	Documentation Studio 1				
Architectural Communication	Architectural Communication				

Course outlines

Name of course	Level	Credits	Description
Contextual studies 1	5	15	Be introduced to key themes and ideas central to the creative industries. This is based on an overview of significant theories informing creative practice across a range of historical and cultural contexts.
Architectural Science	5	15	Develop your knowledge of relevant aspects of building science in order to solve discrete problems as applied to the built environment.
Construction	5	15	Learn about the technologies, materials, manufacturing techniques and construction methods as applied to the built environment.
Architectural Design Studio 1	5	30	Be introduced to the fundamentals, theory and practice of design as it applies to the practice of architecture. Develop visual and presentation skills through drawn media, model making and verbal communication.
Documentation Foundation	5	15	Develop your understanding of methodologies, techniques and processes to present organise and communicate architectural solutions clearly and appropriately, and develop your technical documentation.
Architectural Communication	5	15	Develop your understanding of methodologies, techniques and processes to present organise and communicate architectural design concepts, and develop your perceptual awareness, visual, compositional, observational and conceptual skills.
Documentation Studio 1	5	15	To advance your understanding of methodologies, techniques and processes to present organise and communicate architectural solutions clearly and appropriately, and to advance your technical documentation.
Contextual Studies 2	6	15	Extend your ability to research, analyse and discuss theories shaping creative practice across a range of cultural and historical contexts.
Architectural Technologies	6	30	Further develop your knowledge of relevant aspects of building technologies in order to solve problems as applied to the built environment.
Architectural Design Studio 2	6	30	Extend your understanding of architectural form, space and geometry, surface and textures. Apply theory to real-world scenarios.
Documentation Studio 2	6	30	Further develop your understanding of methodologies, techniques and processes to present, organise and communicate architectural solutions clearly and appropriately.
Research Project	7	15	Develop the skills to conduct and report research under supervision.
Architectural Design Studio 3	7	30	Develop the theory and practice of the design of architecture.
Design studio Major	7	30	Take the opportunity to apply architectural design or documentation activity, and to generate your own focus of study and to work independently in a self-directed manner.
ELECTIVES*			

Building Typologies	7	30	Analyse key design aspects and challenges of various common building typologies and employ key design considerations.
Furniture Design 1	6	15	Develop the theory and practice of designing furniture.
Restoration and Conservation 1	6	15	Explore a range of techniques and principles required for solving design problems relating to the restoration and conservation of buildings.
Sustainable Practice	6	15	Evolve as sustainable practitioners by developing a theoretical and practical understanding of community resilience, place identity and sustainable material cultures.
Furniture Design 2	7	15	Advance the knowledge, skills and awareness that you gained in Furniture Design 1 and develop an enhanced understanding of furniture design.
Computer Aided Communication 2	6	15	Draw, manipulate, customise and manage complex 3D Computer Aided Design Drawings/graphics employing a variety of currently available software packages used by the industry.
New Zealand Architects	7	15	Extend your understanding of the ideas of architectural thinkers and how their concepts informed architectural design in New Zealand.
Architectural Internship	7	15	Embrace the opportunity to operate at an entry level in an Architectural or Interior Architecture design office/practice. You will make a creditable application for ongoing employment in the building industry and self-analyse your performance against employers' expectations. Eligibility for internships is at the discretion of the Programme Leader and requires a minimum of a B grade in all of the following subjects: BACS500, BAAS500, BACT500, BADE500, BADS500 and BADS600 (all of year 1 plus documentation studio 2).
BIM Project	7	15	Learn about the principles of BIM (Building Information Modelling) and its application to collaborative interdisciplinary design, construction and use of building developments. Topics include: project organisation, coding and protocols, BIM deliverables, component standardisation, levels of development, appropriate software, interoperability, project visualisation and design.
Special Topic	6/7	15	Carry out an independent study in your area of speciality.
* not all offered in any one year			

Your workload

Workload is 40 hours per week, with about two thirds of that time spent in a directed learning environment. Learning activities include lectures, seminars, tutorials, Moodle discussion, audio/video analysis, site visits and/or attendance of performances and exhibitions (if available).

Student loans/allowances

Full-time domestic students of this programme are eligible for student loans and allowances (dependent on age and financial circumstances.) Please contact Studylink for additional information. Phone 0800 88 99 00 or visit: www.studylink.govt.nz

Recognition of prior learning

If you already have extensive knowledge and skills gained from practical experience in this area, enquire about our recognition of prior learning process at Capable NZ. You may have already gained credits towards this qualification in the course of your life. www.capablenz.ac.nz

Disclaimer

While every effort is made to ensure that this sheet is accurate, Otago Polytechnic reserves the right to amend, alter or withdraw any of the contained information. The fees shown in this document are indicative ONLY. Both domestic and international fees are subject to change and are dependent on the development and implementation of Government policies. Please note that additional fees may from time to time be required for external examination, NZQA fees and/or additional material fees.

International **+64 3 477 3014**
New Zealand **0800 762 786**
Email **info@op.ac.nz**

Dunedin Campus
Forth Street, Dunedin
Private Bag 1910
New Zealand 9054

Central Otago Campus
Corner Erris & Ray Streets
PO Box 16, Cromwell
New Zealand 9342

Auckland Campus
Level 2, 350 Queen Street
PO Box 5268, Auckland
New Zealand 1141